

Design and works execution for:

"Rehabilitation and development of historical monument - Golia Monastery - ACCES INFRASTRUCTURE - TRAMWAY TRACK"

Duration of works:

2009 - 2010

Beneficiary:

Iasi City's Council

Financing source:

PHARE 2004 - 2006 Funds Big Regional Infrastructure Projects

Short description of the works:

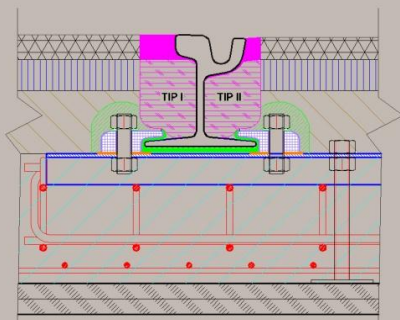

- **execution of 0,99 km single tram track**, embedded, on concrete slabs, using grooved rails type Ri60N (60R2), with electrical insulation of the rails and diminution of the noises and vibrations;
- tram track infrastructure, superstructure and overhead contact line construction;
- installation of 8 turnouts (including the Turnout Control and Signaling System, Switch Machine for grooved rail and T-rail turnouts, Point Heating System and Stationary track lubrication system);
- at the construction of the tram track was used the direct fastening system on steel sleepers with seen reinforcement, **system designed by Martin Rose Romania.**

